

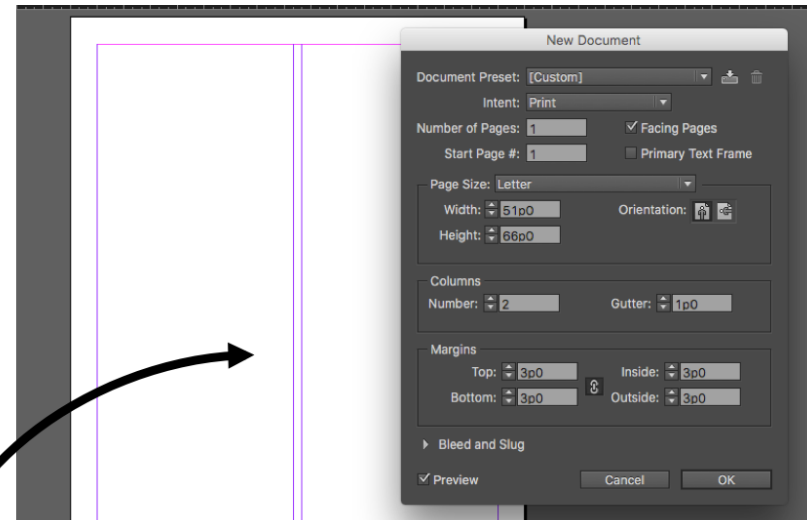

Adobe
InDesign

Creating a Document in InDesign

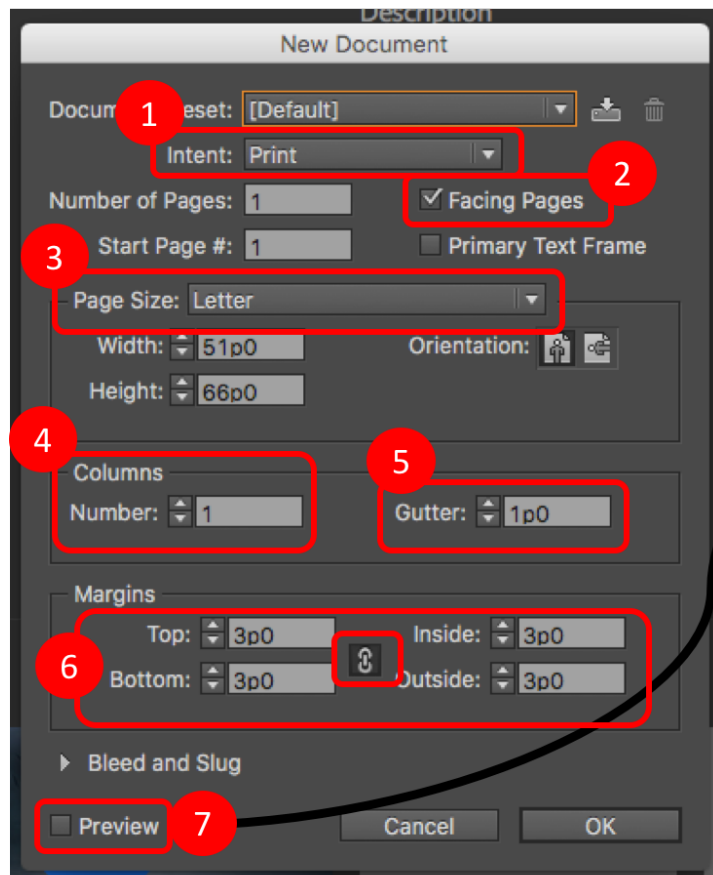

1. How will you be publishing?
2. Will you have page spreads?
3. What size will your pages be?
4. Would you like to add columns to your template? How many?
5. If you add columns, how much space do you want between them?
6. How much margin space do you want to create?
7. Turn on preview to see what your choices look like live!

InDesign Dashboard

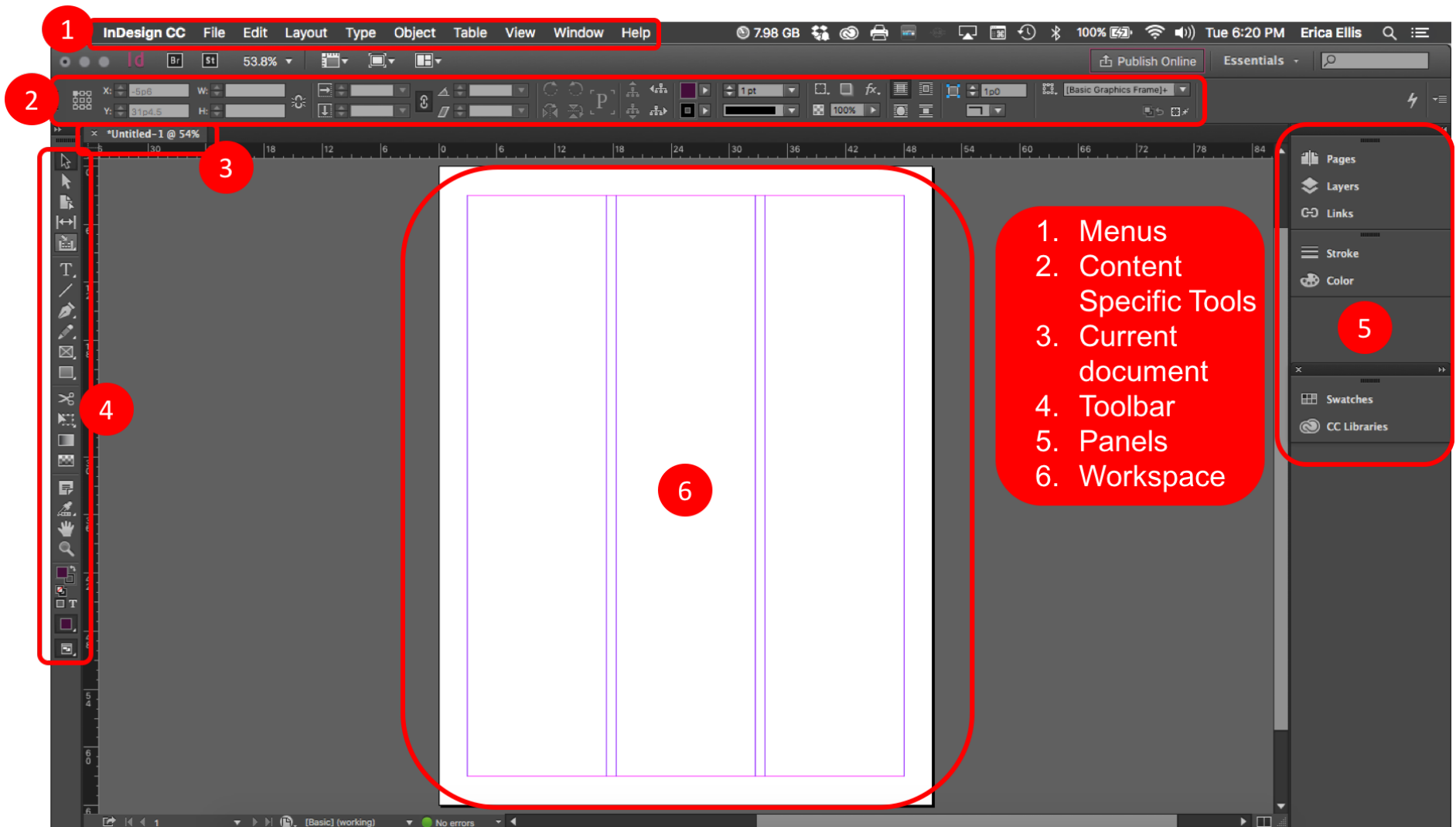

Managing Pages

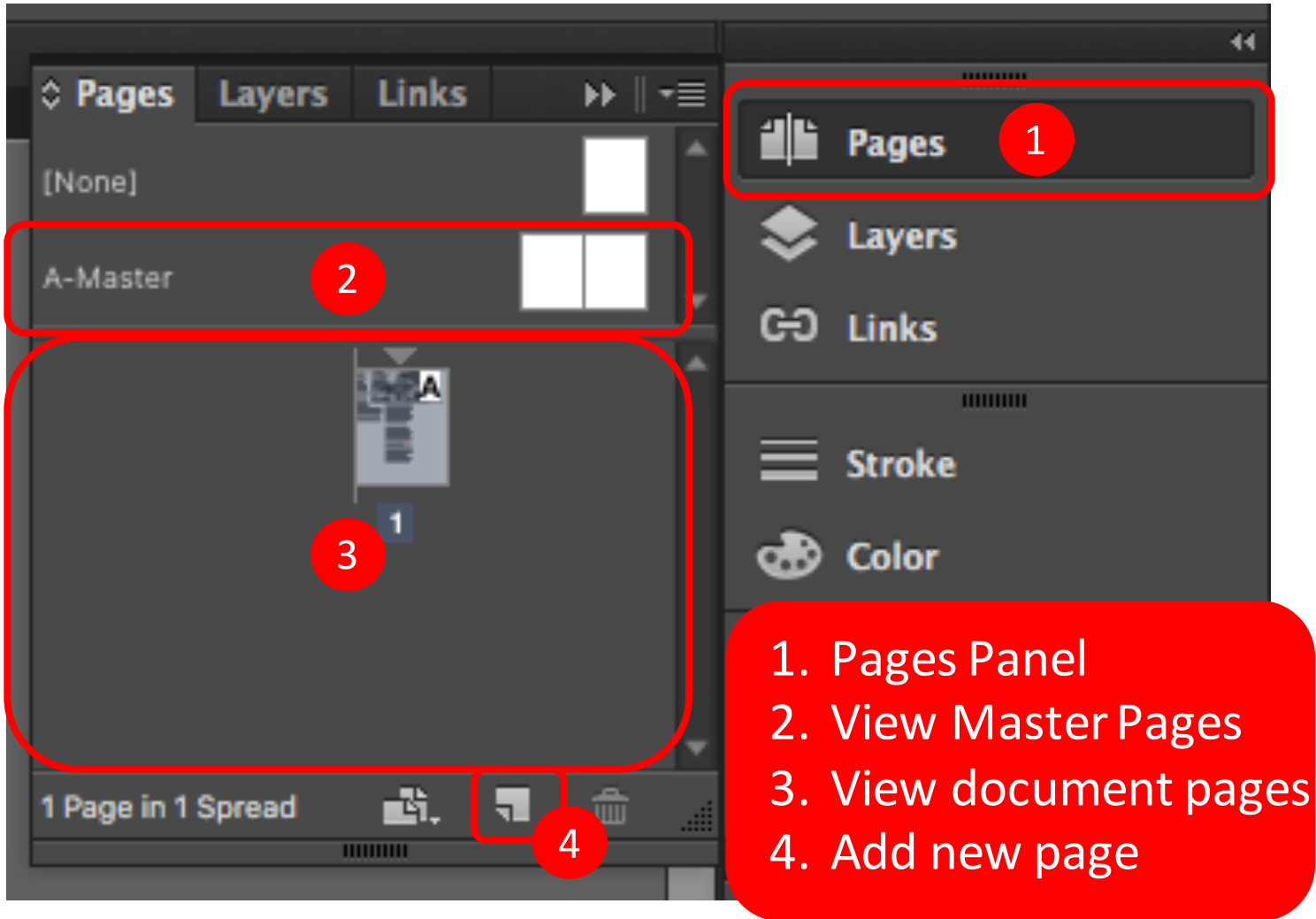

Placing Text

To place text

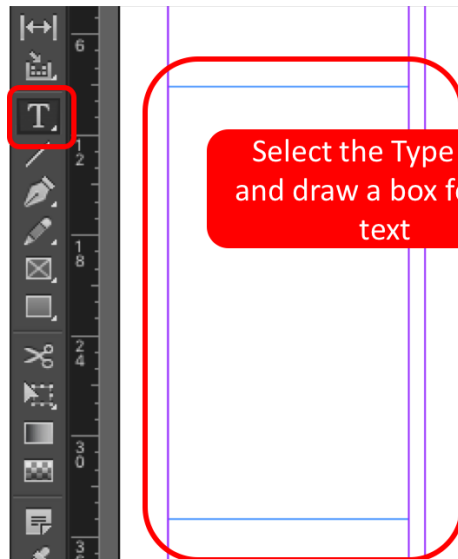

Select the Type Tool
and draw a box for the
text

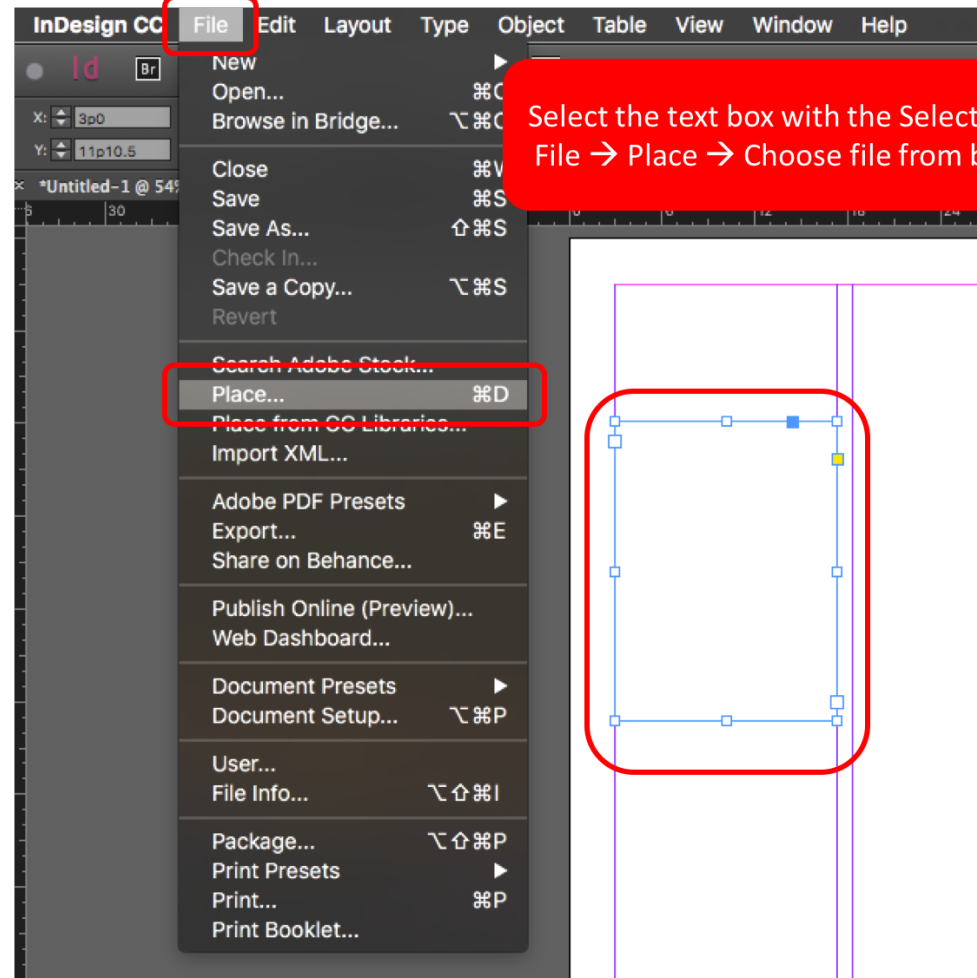

Select the text box with the Selection Tool
File → Place → Choose file from browser

Linking Text Boxes

If your text is too large for your text box

The diagram shows three stages of text box linking. The first stage shows a single text box containing text that is too long to fit. A small red plus sign appears at the bottom right corner of the box. The second stage shows the text being split into two boxes, with the second box starting with the text 'high in the sky.' The third stage shows the text being split into three boxes, with the third box starting with the text 'Jerome sits like a speck'. Red callout boxes provide instructions: 'A small red plus sign will appear at the end of the box' points to the plus sign in the first stage; 'Create a new text box where you would like the text to flow to and drag the red plus sign into the new box' points to the plus sign being moved into the second box in the second stage.

It's 2012, and driving down the I-17 past Sedona and nearing the familiar exit to Cottonwood, you can see a small speck of lights shining off in the distance. There's not much, and if the nights in the Verde Valley were not so dark, you may not be able to see the lights at all. Raise your thumb up to the space and you can make the little patch disappear, but they are strange, eerily climbing up a patch of blackness in the night sky where they could be floating – a city a mile

It's 2012, and driving down the I-17 past Sedona and nearing the familiar exit to Cottonwood, you can see a small speck of lights shining off in the distance. There's not much, and if the nights in the Verde Valley were not so dark, you may not be able to see the lights at all. Raise your thumb up to the space and you can make the little patch disappear, but they are strange, eerily climbing up a patch of blackness in the night sky where they could be floating – a city a mile

high in the sky.

Jerome sits like a speck on slope of d under a mountain, Photo 1 area where mines are sunk into the ground and the roads wind quickly up and around the mountain, marked with speed limit signs that seem to be too fast to be safe on the narrow lanes. The only people who seem to enjoy the quick cruise are those on roaring bikes with their dark leather jackets

A small red plus sign will appear at the end of the box

Create a new text box where you would like the text to flow to and drag the red plus sign into the new box

Placing an Image

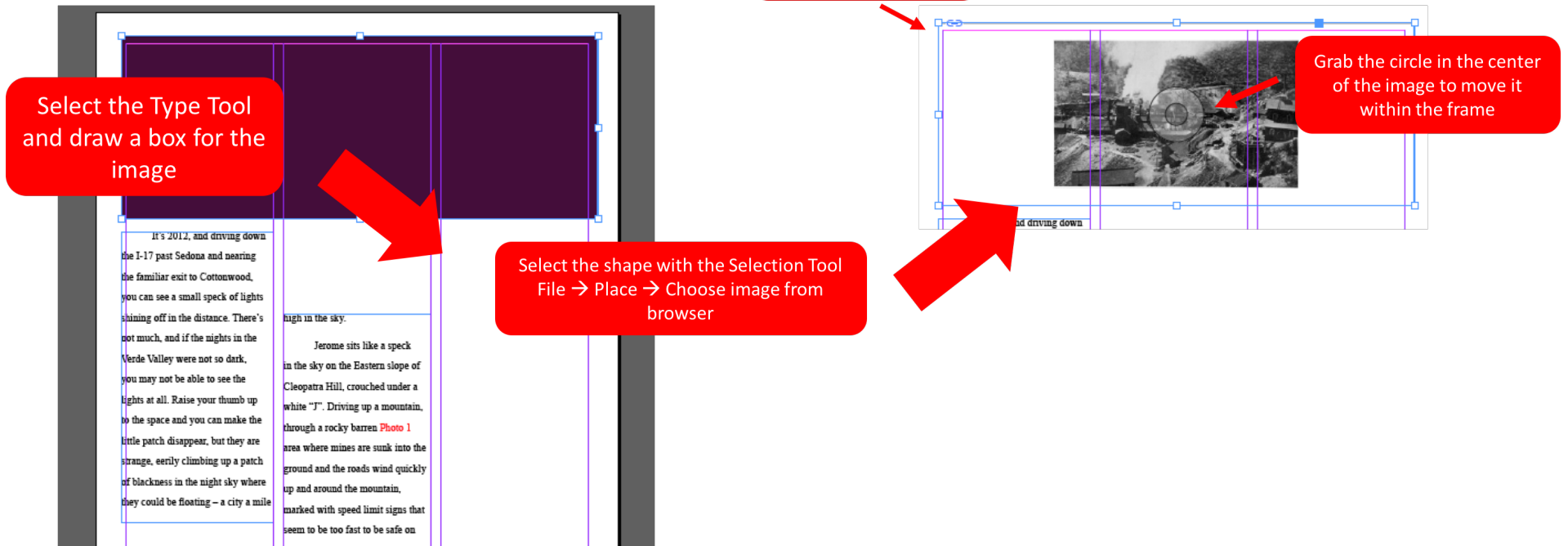

Adjusting Placed Images

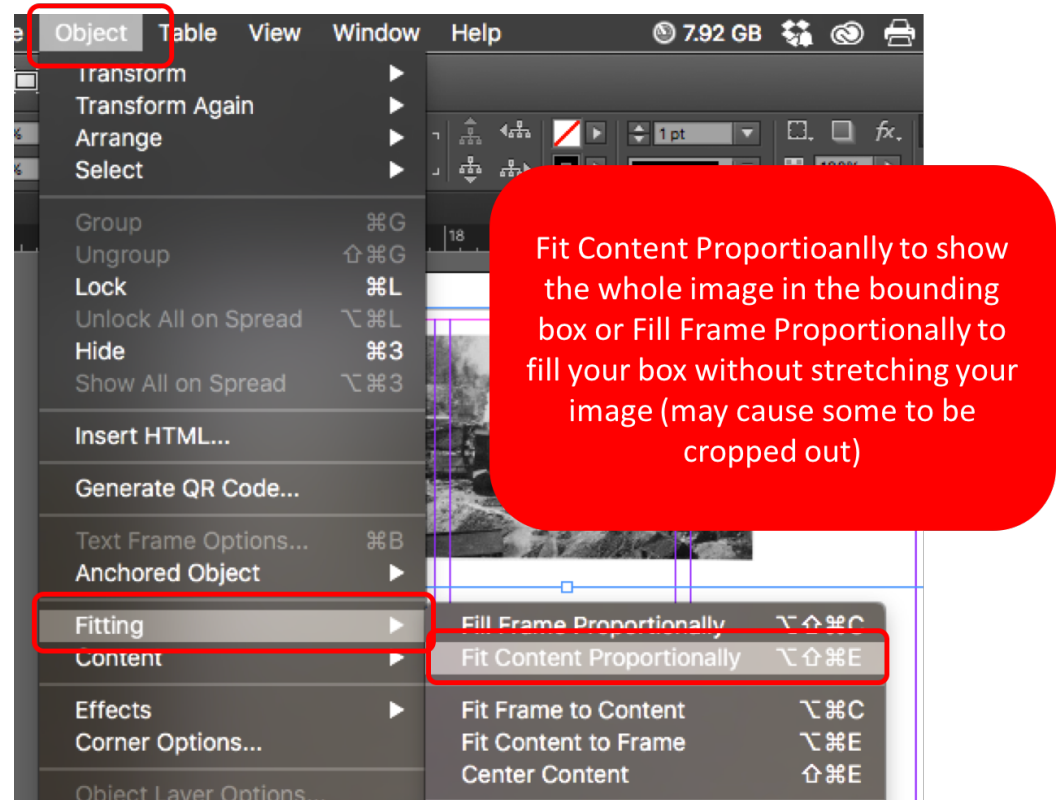
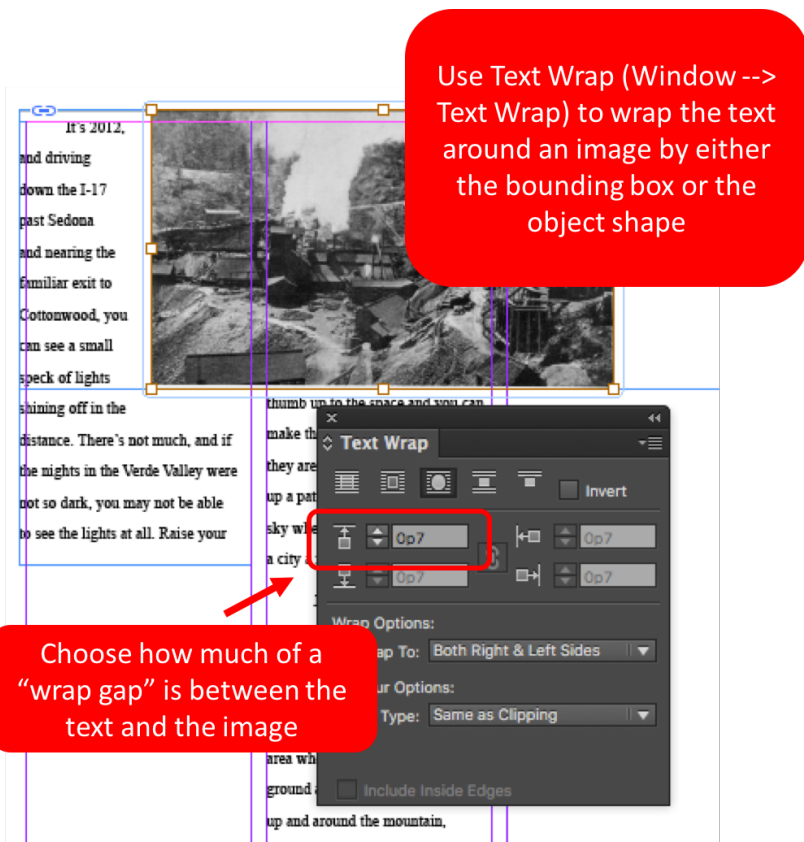

Managing Colors

Open Color Panel

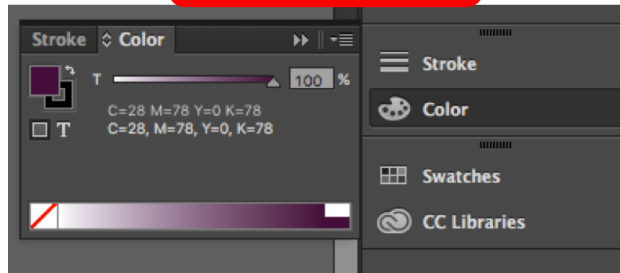

Choose CMYK from arrow menu

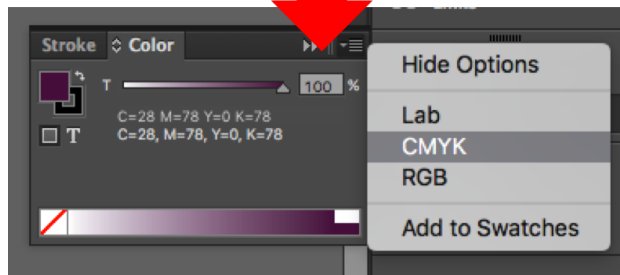

Choose Color

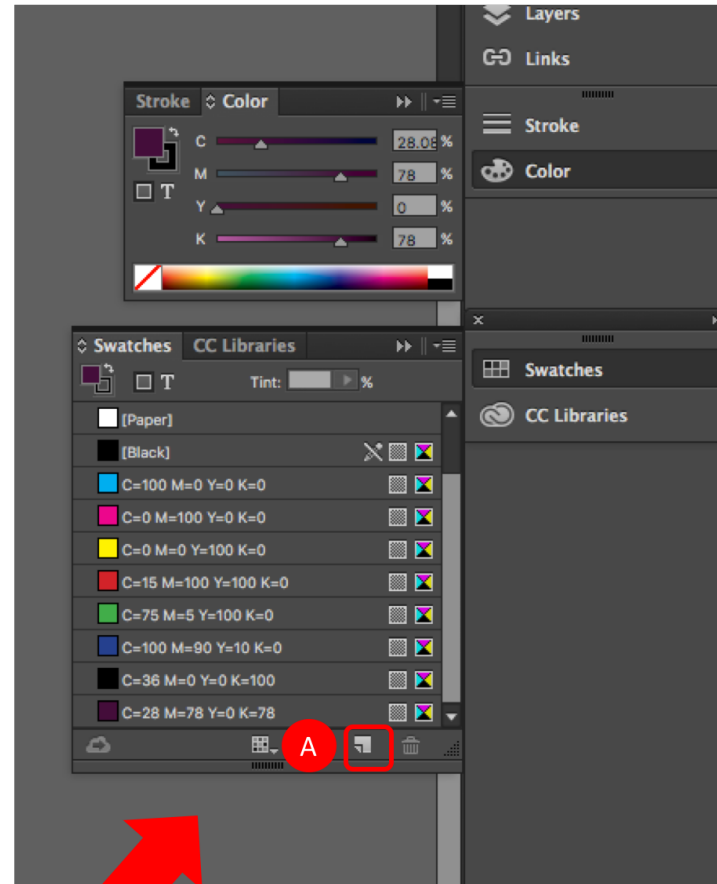
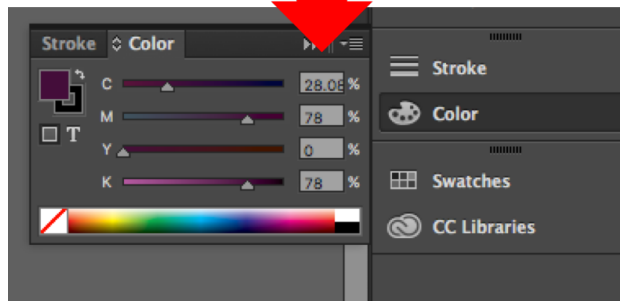

Click and pull down the Swatches menu area so they can be open at the same time. To save a color to your swatch click the New swatch icon (A).

Master Page Numbers

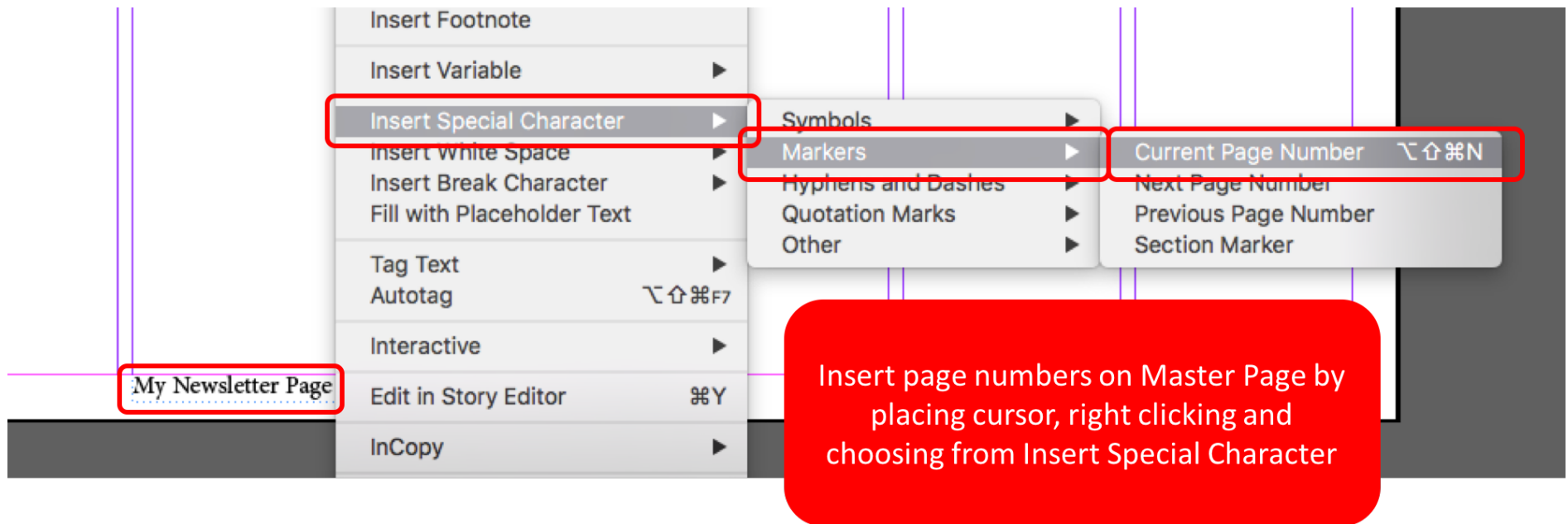

Other Helpful Info

- Hold the shift key while drawing an ellipse to create a perfect circle
- Push back an object layer from Object --> Arrange
- Choose Type on a Path tool from the Type Tool to type along the edge of a shape you have placed
- Change object opacity (transparency) under Object --> Effects --> Transparency --> Opacity